

TISSUE SAMPLER

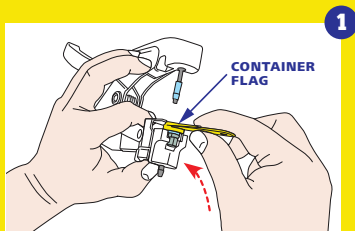

INSTRUCTIONS

Z
TAGS
DATAMARS



1 Push the metal plate up and slide the container tag underneath it. Make sure the container is firmly clipped into the tagger. Clip the container flag onto the tagger lug.

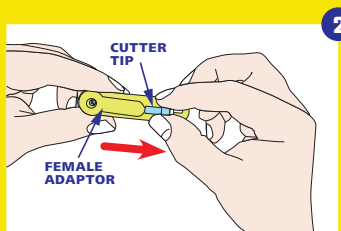

2 Remove the blue cutter tip from the tag ensuring that you leave the female adaptor clipped onto the container.

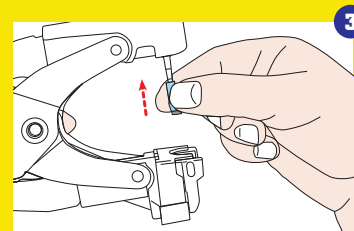

3 Load onto the tagger pin.

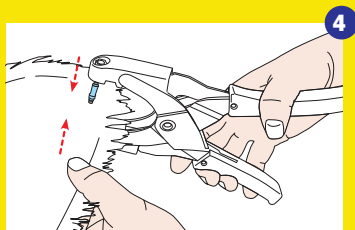

4 Before taking the sample, check that the cutter tip is present. Compress the tagger handles completely to take the sample.

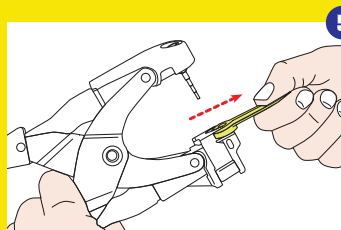

5 Remove the container tag from the tagger, pull off the female adaptor and ensure that the blue male adaptor comes away with the female adaptor. Check for the presence of the cutter tip in the container to confirm a sample has been taken. If you can't see the cutter tip in the container take a new sample.

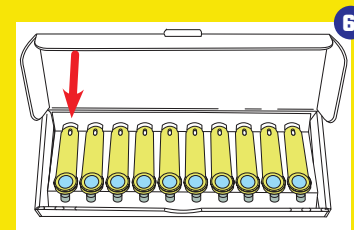

6 Write VID numbers, along with contact details on the info card provided. Return samples to box and send to your preferred laboratory.